



DCAC 500,1200 & 2000

Instructions Manual

Contents

Safety Considerations	2	Accessories	6
Technical Data	3	Trouble Shooting	7
Description	3		
Operation	5	Spare Parts _____	
Service	4		
Assembly	6		

Safety Considerations

Read all instructions before attempting to operate this machine and save these instructions.

Warning! When using electric machines, basic safety precautions should always be followed to reduce the risk of fire, electric shock and personal injury, including the following:

1. Important!

No hot particles nor ignition sources are allowed to be sucked into the unit. The machine should not be used for explosives, unstable or pyrophoric particles or dust.

— **WARNING!** Operators shall be adequately instructed on the use of these machines.

— **WARNING!** This machine is for dry use only.

— **CAUTION!** This machine is for indoor use only.

— **CAUTION!** This machine shall be stored indoors only.

2. Work area environment

Don't expose the machine for rain. Don't use it in damp or wet locations or in presence of flammable liquids or gases.

3. Overload

Never let the machine operate fully throttled. Always follow the regulations pertinent to the material you are working with. Don't use the machine for purposes that it isn't intended for.

4. Don't abuse cord

Never pull the machine by the cord. Keep the cord from heat and sharp edges. Check the electric cable regularly for damage.

5. Important measure

With cleaning and maintenance on the machine, the power cable should be disconnected from the supply. Only use the machine complete.

6. Maintain the machine with care

Keep the machine clean and check that the hose (extra accessories) is undamaged and that all gaskets are tight. Follow instructions. Keep handles dry and free from oil and grease. Make sure the micro-filter is fitted properly.

7. Checking for damage

Before further use of the machine it should be carefully checked that the machine is undamaged. If there are any damaged parts these should be repaired by a CAS-HIRE authorized service center.

8. Warning

Use only accessories and replaceable parts which are available from CAS-HIRE. When using faulty parts or pirate parts (especially filter) the machine could leak out unhealthy dust which can cause personal injuries.

This appliance is not intended for use by persons (including children) with reduced physical, sensory or mental capabilities, or lack of experience and knowledge, unless they have been given supervision or instruction concerning use of the appliance by a person responsible for their safety. Children should be supervised to ensure that they do not play with the appliance.

This machine is intended for commercial use only, for example in hotels, schools, hospitals, factories, shops, offices and rental businesses.

The machine is not designed to be lifted by the handle of a crane or other lifting device.



Technical Data

	DCAC 500	DCAC 1200	DCAC 2000
HxWxL	380 x 340 x 495 mm	869 x 458 x 598 mm	1019 x 512 x 547 mm
Weight	13 kg	21 kg	25 kg
In-/Outlet	Ø 125 mm	Ø 250/315 mm	Ø 315 mm
Flow, at open outlet	500 m³/h	1060 m³/h 50 Hz, 860 m³/h 60 Hz	1850 m³/h 50 Hz, 1650 m³/h 60 Hz
Power consumption	230 V, 210 W 115 V, 195 W	230 V, 385 W, 115 V, 375 W	230 V, 505 W, 115 V 0 W
Degree of separation, EN 60335-2-69, class H	99,995 %	99,995 %	99,995 %
EN 1822-1	HEPA 13	HEPA 13	HEPA 13
Pre-fi			
lter "cartridge"	G3	G3	G3
Area pre-filter and HEPA filter	0,18/4,56 (m²)	0,48/5,49 (m²)	0,5/8,16 (m²)
Soundlevel*/		max 60 - 69 dB(A)	max 62 - 74 dB(A)
Speed 1	45 dB(A)		
Speed 2	65 dB(A)		

*/ Sound level at 1,6 m height and 1 m distance according to DIN EN ISO 3744 in free space and at maximum airflow.

Description

The DC AirCube air cleaner is intended for cleaning the air in a work area and is intended for use as a complement to spot extraction. Air is passed through a combination filter and a HEPA filter. The HEPA filter actually separates particles to 99.995 %. The combination filter separates the majority of the particles and thereby prolonging the life of the microfilter.

When a loss of suction capacity is experienced the pre-filter should be changed. If the suction capacity does not increase after the pre-filter change then the HEPA filter should also be changed.

The fan has two speed settings which allow for economical running, for example during the night.

The DCAC 1200 can also be used to discharge air from work places which must be kept under negative pressure. A 250 mm hose can be attached to the fan outlet where necessary.

The DCAC 2000 can also be used to discharge air from work places which must be kept under negative pressure. A 315 mm hose can be attached to the fan outlet where necessary.

Without accessories the machine is made for using in an upright position to minimise dust whirling from the outlet.

Service DCAC 500

While performing cleaning or maintenance on the machine, the unit should be off and disconnected from the power supply.

When the suction is reduced, due to the filters becoming clogged. The pre-filter should be changed. Turn the "soft" surface out and the "hard" surface towards the HEPA-filter.

If the suction still is weak, the HEPA filter should be changed too. With heavy dust loads the life of the filters are shorter. Use only original spare part filter 4080. Use suitable breathing protection and do the operation in a closed room. The used filter should be sealed in a plastic bag and disposed of according to approved methods.

Montage:

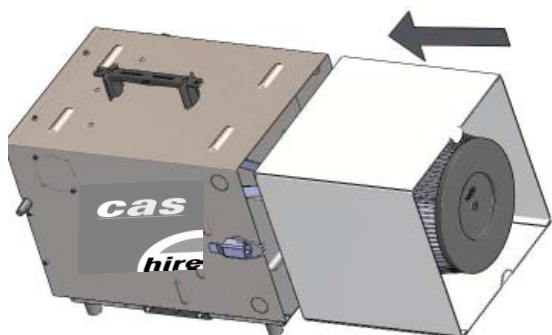

Montage of prefilter:

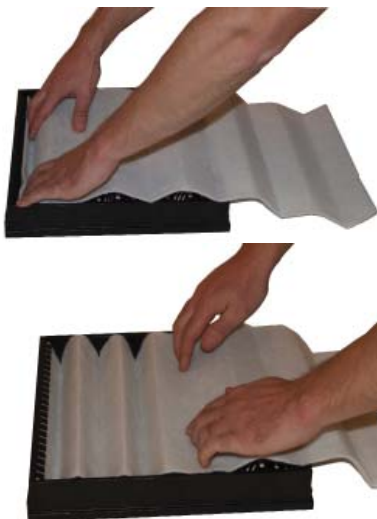

Check regularly that the electrical cable is not damaged in any way. With replacement of the cable and contact, use only water proof replacements.

The DCAC 500 should be performance tested and checked at least once per year or more frequently if subject to intensive use.

Because this machine is used with dangerous substances maintenance is vital, worn parts should be replaced.

Never compromise the function of the DCAC 500, use only original spare parts. The fan is maintenance free.

- When light is on, it's time for service!

Change of prefilter:

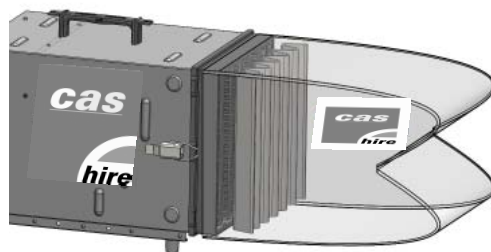

Change of HEPA filter:

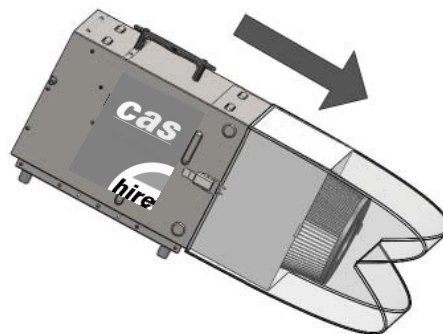

Service DCAC 1200, 2000

While performing cleaning or maintenance on the machine, the unit should be off and disconnected from the power supply.

When the suction is reduced, due to the filters becoming clogged, the red light will come on. (Note: This feature is only at max speed.)

The pre-filter should be changed. If the light is still on the the HEPA filter should be changed too.

With heavy dust loads the life of the filters are shorter. Use only original spare part filter. Use suitable breathing protection and do the operation in a closed room. The used filter should be sealed in a plastic bag and disposed of according to approved methods.

Check regularly that the electrical cable is not damaged in any way. With replacement of the cable and contact, use only water proof replacements.

The DCAC 1200, 2000 should be performance tested and checked at least once per year or more frequently if subject to intensive use.

Because this machine is used with dangerous substances maintenance is vital, worn parts should be replaced.

Never compromise the function of the DCAC 1200, use only original spare parts.

The fan is maintenance free.

Change the filter:

DCAC 1200

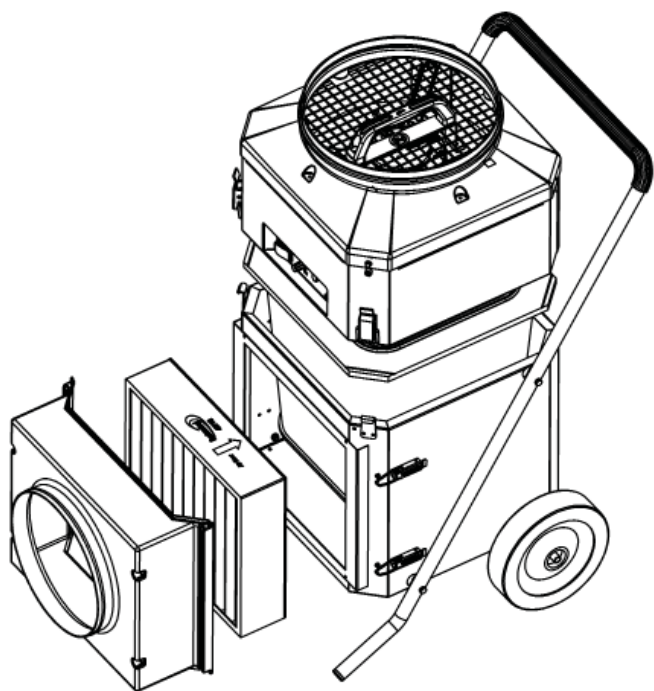

DCAC2000

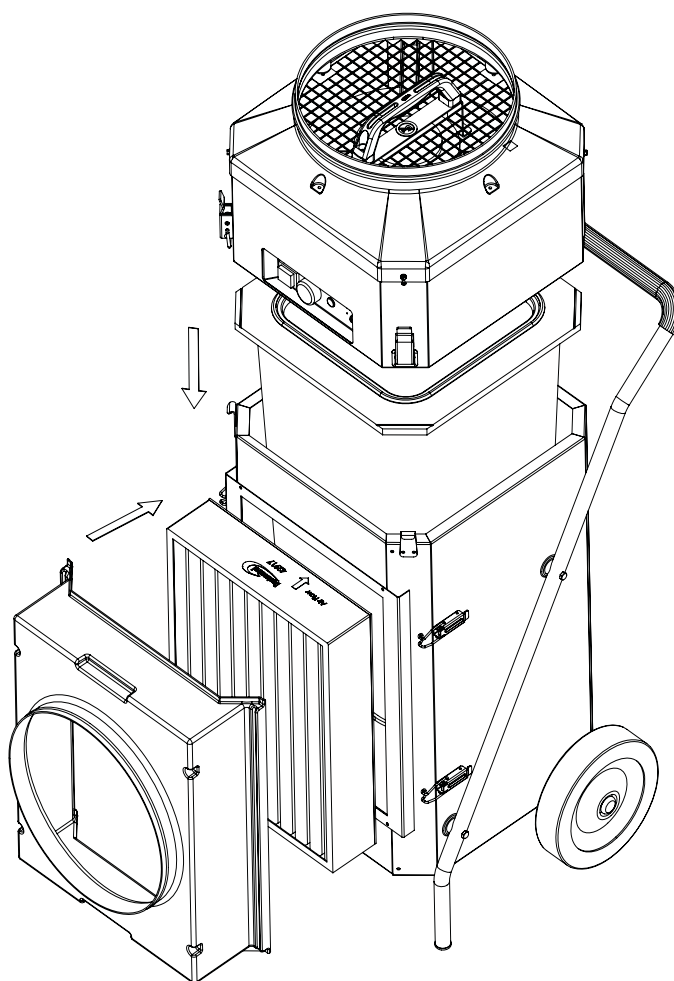

Assembly DCAC 1200, 2000

DCAC 1200

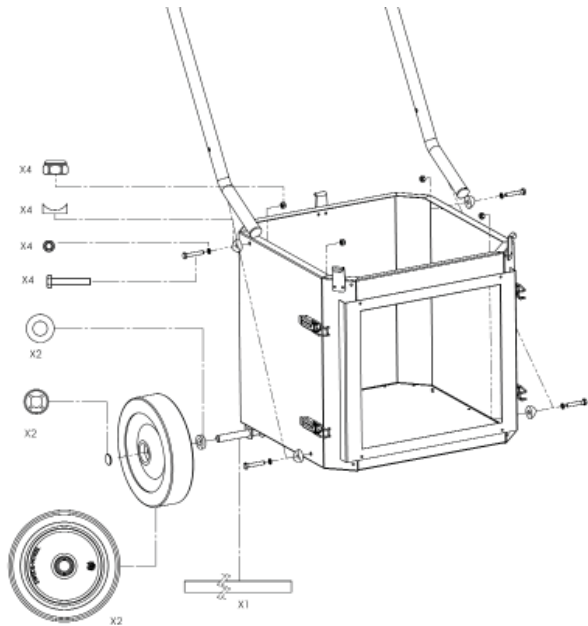

DCAC 2000

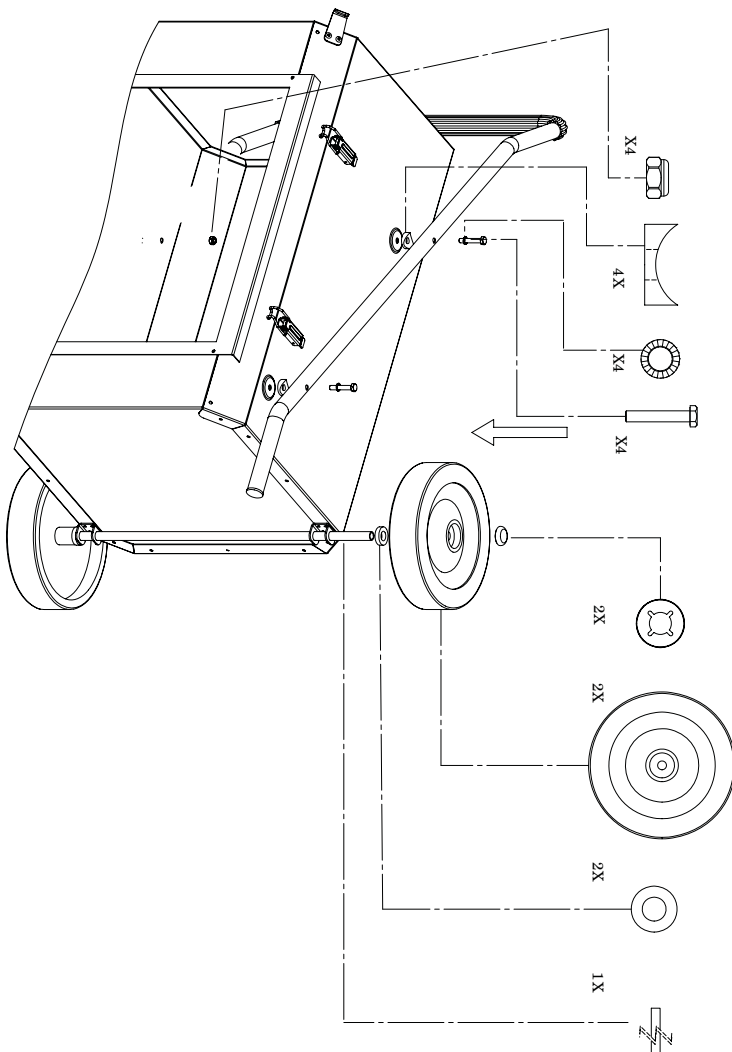

Accessories DCAC 500

Description Part no

Hose \varnothing 125 mm	2420
Hose clamp	4138
Prefilter	42690
Microfilter	42692
Funnel	42753
Bracket	42724
Inlet protection asbest	44091

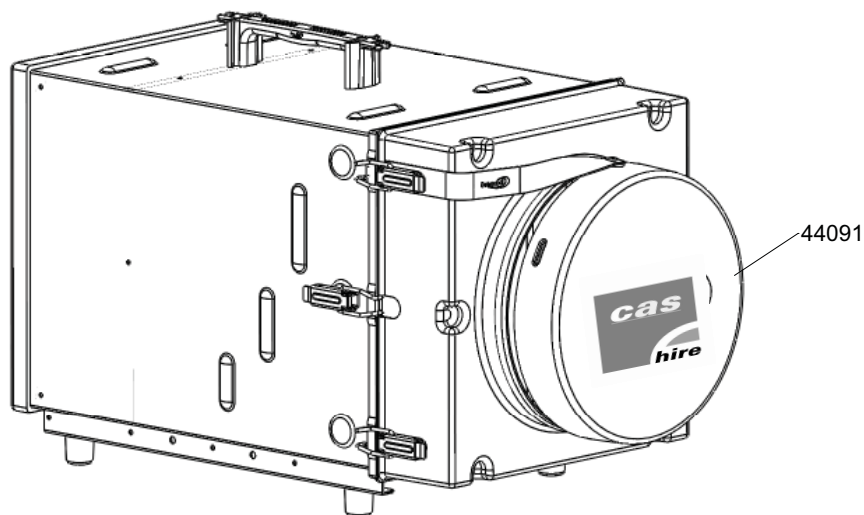
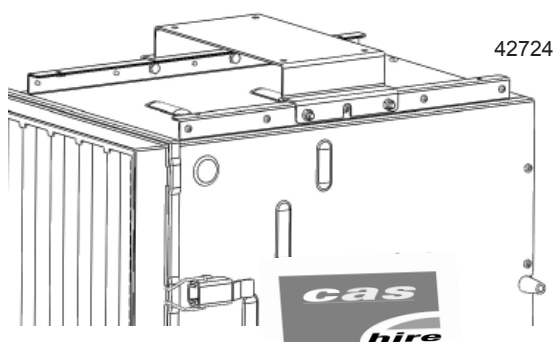
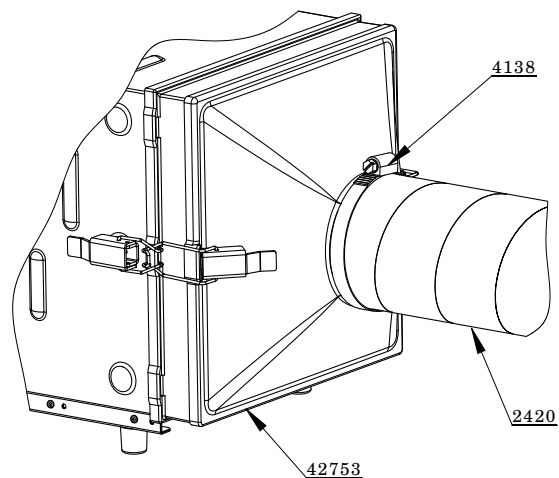

Accessories DCAC 1200, 2000

DCAC 1200

Description Part No

Prefilter	42918
Prefilter carbon	42938
Microfilter	42940

DCAC2000

Description Part No

Prefilter	42917
Microfilter	42896
Hose/socket/clip 315 mm	42657
Socket/bend 90° 315 mm	42660
Prefilter carbon	42937

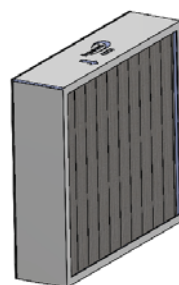

42937
42938

42657



42660



Other accessories

TROUBLE SHOOTING

Problem	Fault	Solution
Machine blows dust.	Damaged filter or gasket.	Change filter.
Machine runs only on max speed.	Turning power meter is faulty.	Order parts and replace.
Reduction in airflow at exhaust.	Filled filter.	Change filter.
Fan does not start.	No power.	Check power source and connection.